

## PDF technical sheet 22219EMW33



### Double row spherical roller bearings

Spherical roller bearing, one-piece machined cage, groove and lubrication holes on outer ring

Product definition	
d	3.7402 "
D	6.6929 "
B	1.6929 "
D1	6.0157 "
rs min	0.0827 "
Number of lubrication holes	3
b	0.3898 "
k	0.1772 "
e	0.23
Y1	2.95
Y2	4.4
Y0	2.89
Radial clearance class	CN
Mass	14.43 oz
Brand	SNR

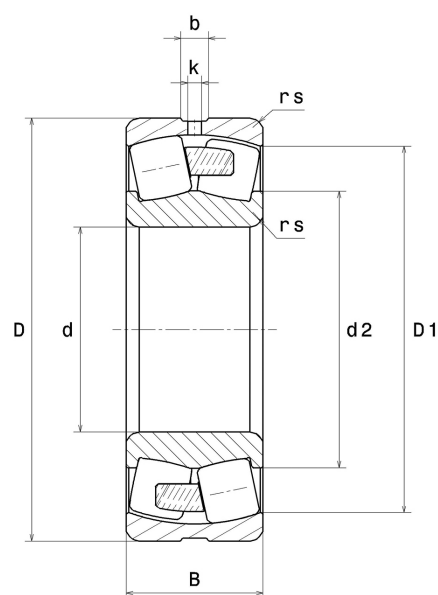

Product performance	
Dynamic load, C	416 kN
Static load, C0	417 kN
Fatigue limit load, Cu	47.50 kN
Nref	3,800 RPM
Nlim	4,800 RPM
Min operating temperature, Tmin	-40 °C
Max operating temperature, Tmax	392 °C
Characteristic cage frequency, FTF	0.42 Hz
Characteristic rolling element frequency, BSF	5.95 Hz
Characteristic outer ring frequency, BPF0	7.12 Hz
Characteristic inner ring frequency, BPF1	9.88 Hz

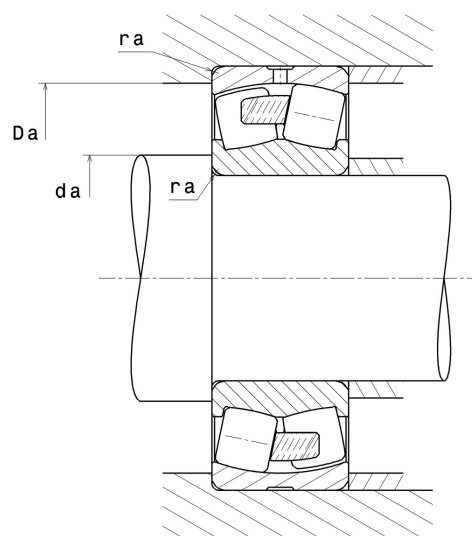

### Abutment dimensions

da min	4.2126 "
Da max	6.2205 "
ra max	0.0787 "

### Calculation factors

#### Equivalent dynamic radial load

$$P = X.F_r + Y.F_a$$

Fa / Fr ≤ e		Fa / Fr > e	
X	Y	X	Y
1	Y1	0.67	Y2

#### Equivalent static radial load

$$P_0 = X_0.F_r + Y_0.F_a$$

X <sub>0</sub>	Y <sub>0</sub>
1	Y0

The values for e, Y1, Y2 and Y0 are shown in the above table .